

Replacing The Battery

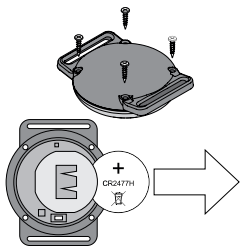

DO NOT dispose of batteries in fire. Batteries should be recycled or disposed of as per your local guidelines.

Replace the lid ensuring the silicone insert is not damaged and the screws go through the holes correctly DO NOT overtighten the screws.

Ultimate Sports Engineering Ltd
United Kingdom

+44 (0) 1798 839 300

alertandfind@use.group

alertandfind.com

 alertandfind



Terms & Conditions:
alertandfind.com/termsandconditions

Setup/Installer/Preparar/
Konfiguration/Impostare

Download OLAS App

Télécharger l'application OLAS

Descargar la aplicación OLAS

Herunterladen OLAS App

Scarica OLAS App



Ⓒ Ensure your phone or tablet has;

- maximum volume
- charged battery
- GPS ON
- Bluetooth ON

Ⓕ Assurez-vous que votre téléphone ou tablette a;

- volume maximal
- batterie chargée
- GPS activé
- Bluetooth activé

Ⓖ Asegúrese de que su teléfono o tableta tiene;

- volumen máximo
- batería cargada
- GPS activado
- Bluetooth activado

Ⓓ Stellen Sie sicher, dass Ihr Telefon oder Tablet folgendes anzeigt;

- maximale Lautstärke
- aufgeladener Akku
- GPS EIN
- Bluetooth EIN

Ⓘ Assicurati che il tuo telefono o tablet ha;

- volume massimo
- batteria carica
- GPS ON
- Bluetooth ON

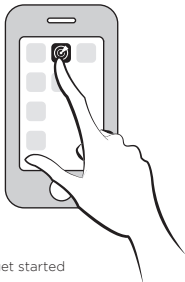

Open to get started

Ouvrir pour commencer

Abrir para empezar

Öffnen Sie, um zu beginnen

Aperto per iniziare

⚠ Warning: Any change or modification to this unit not expressly approved by the party responsible for compliance could void the user's authority to operate the equipment.

NOTE: This equipment has been tested and found to comply with the limits for a Class B digital device, pursuant to Part 15 of the FCC Rules. These limits are designed to provide reasonable protection against harmful interference in a residential installation. This equipment generates, uses and can radiate radio frequency energy and, if not installed and used in accordance with the instructions, may cause harmful interference to radio communications.